

PERFORMANCE V630W USER MANUAL

Please read this manual thoroughly before using and keep it for future reference.

PACKING LIST



PERFORMANCE V630W



Remote
(Batteries Not Included)



Carrying Bag



User Manual



AV Cable

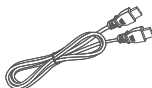

HD Cable

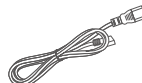

Power Cable

NOTICE

Recommended

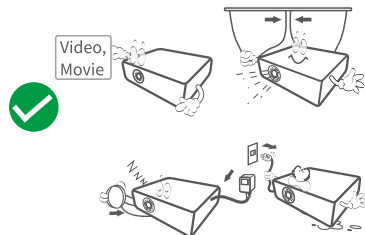

NOT Recommended

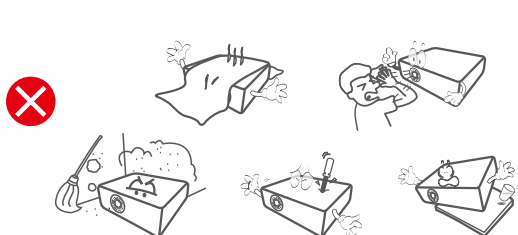

FUNCTION OVERVIEW

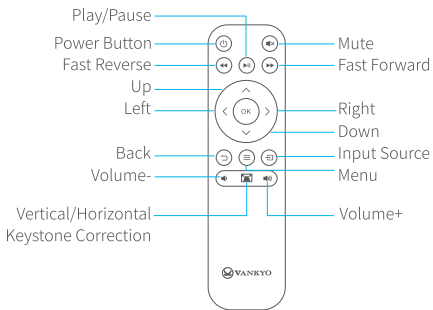
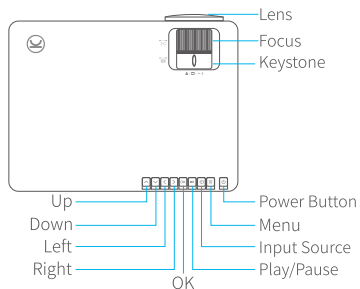
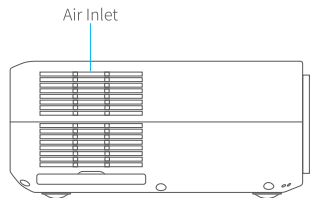
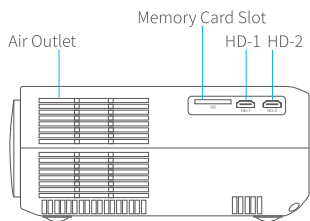
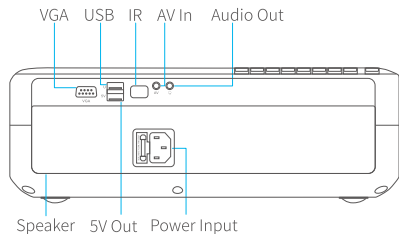

QUICK START

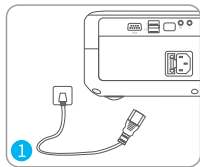

Plug the power cord into an outlet.

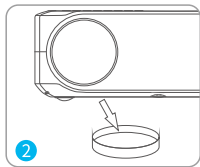

Take off the lens cover.

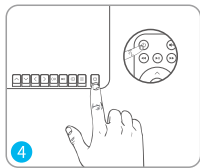

Press the **Power Button** to turn on the projector.

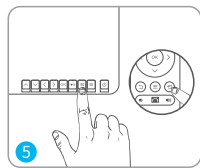

Select the correct input source to project your device.

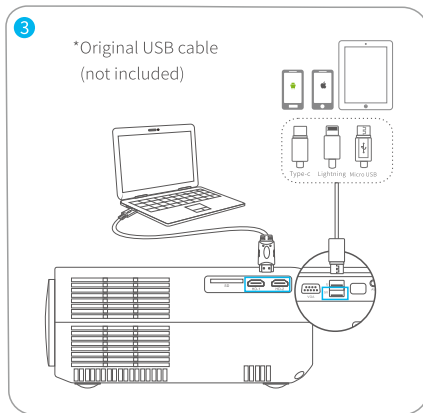

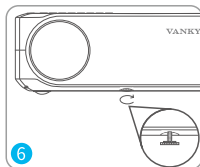

*Original USB cable (not included)

Connect your device to the projector correctly.

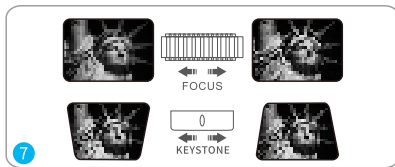

Adjust the kickstand accordingly.



Adjust the focus ring and keystone to get the best image performance. (Press  on the remote to correct the image shape as needed.)

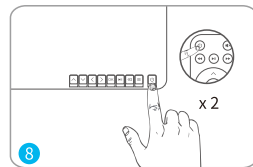

Press the **Power Button** twice to turn off the projector.

KEYSTONE CORRECTION

Option 1: Adjust the keystone on the projector to adjust the image shape.

Option 2: Press  on the projector/remote, then select **OPTION > Keystone**. Press the   button to select from **H. Calibration, V. Calibration** and **Auto Adjust**, then press   to start correcting the image shape.

Vertical & Horizontal Correction

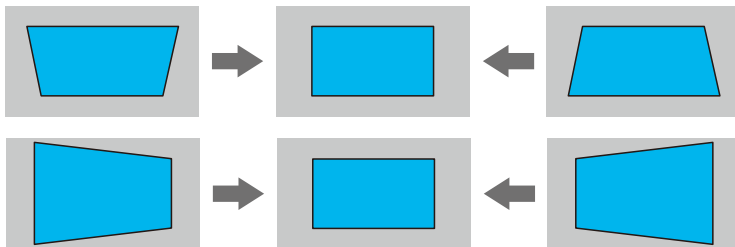

Tips:

- * If you select **Auto Adjust**, the projected image will perform a vertical adjustment automatically.
- * The range of the digital keystone correction is $\pm 50^\circ$. To optimize your view experience, please keep the keystone under 25° if digital adjustment is needed.

INPUT SOURCE

Press  on the projector/remote to enter the interface of **Input Source**.

A. Screen Mirroring

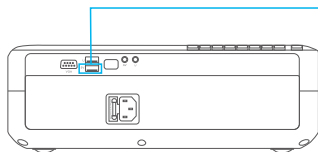

Input Source
VGA
HD1
HD2
Screen Mirroring
AV
USB
SD

B. VGA Connection

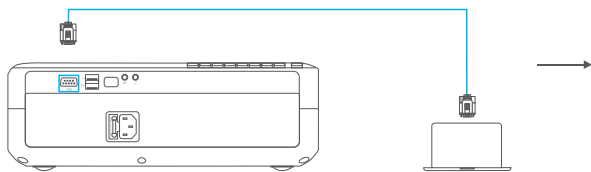

Input Source
VGA
HD1
HD2
Screen Mirroring
AV
USB
SD

C. HD Connection

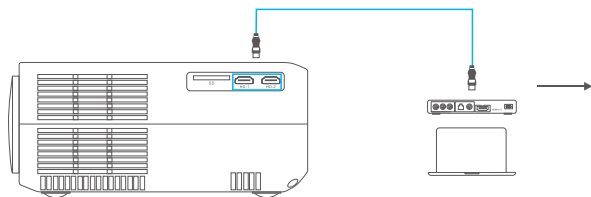

Input Source
VGA
HD1
HD2
Screen Mirroring
AV
USB
SD

D. Multimedia Connection

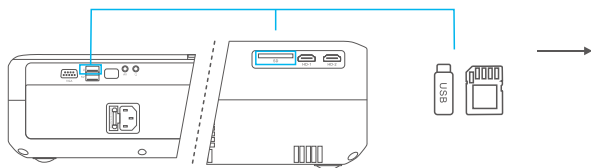

Input Source
VGA
HD1
HD2
Screen Mirroring
AV
USB
SD

PROJECTOR CONNECTION

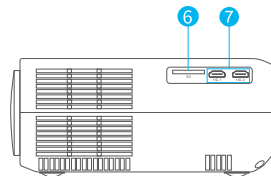
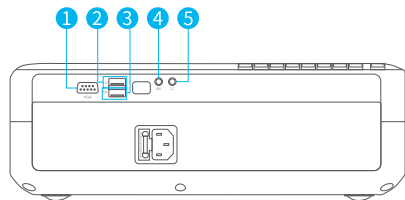

1



2

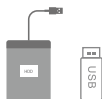

3



4



5



6



7



SCREEN MIRRORING

Important:

- 1 Before screen mirroring, please press the  button on the projector/remote to enter the interface of **Input Source** and select **Screen Mirroring**.
- 2 Press OK button on the projector/remote to switch the interfaces between **Screen Mirroring for iOS System** and **Screen Mirroring for Android System**.

Screen Mirroring through Wireless Connection

For iOS System

* Streaming with cellular data

1. Turn on the projector, select **Screen Mirroring** as the input source to enter the interface of **Screen Mirroring for iOS System**.



2. Go to the settings of your iOS mobile device and connect it to the WiFi of **Performance-V630W-XXXXXX** (pwd: 12345678).
3. Activate **Screen Mirroring/AirPlay Mirroring** on your iOS device and search for the projector.

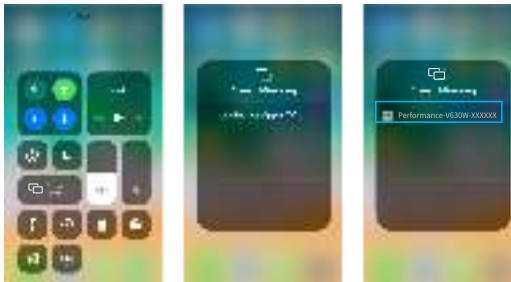

4. Select **Performance-V630W-XXXXXX** from the searching results to connect.
5. The display of your iOS mobile device will be projected to the wall/screen via cellular data after a successful connection.

* Streaming with your router's WiFi

1. Turn on the projector, select **Screen Mirroring** as the input source to enter the interface of Screen Mirroring for iOS System.



2. Go to the settings of your iOS mobile device and connect it to the WiFi of **Performance-V630W-XXXXXX** (pwd: 12345678).
3. Visit <http://192.168.49.1> from a browser on your mobile device, tap **WiFi AP** > **Scan**, select your router's WiFi and enter the right password, then tap **Connect** to continue.

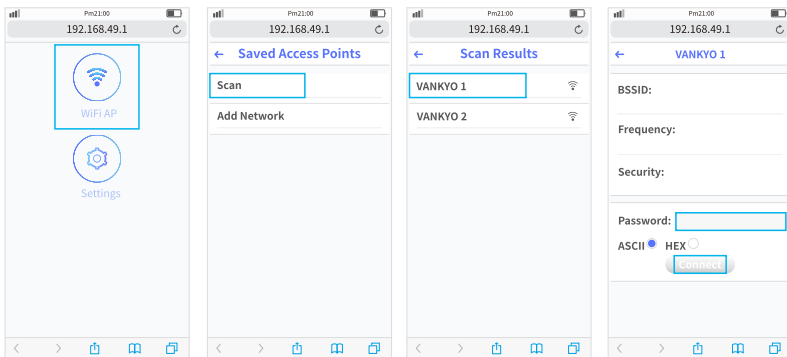

4. Your router's WiFi will be displayed on interface of Screen Mirroring for iOS System after a successful connection.



5. Get back to the WiFi setting of your iOS mobile device, then connect it to the same router's WiFi.
6. Activate **Screen Mirroring** on your iOS device and search for the projector, then select **Performance-V630W-XXXXXX** from the searching results to connect.
7. The live streaming content from your iOS mobile device will be projected to the wall/screen through WiFi connection.



Tip:

If you'd like to connect to another router's WiFi, please repeat the procedures mentioned in the section of **Streaming with your router's WiFi**.

For Android System

To activate this function, your Android device must support **Multi-Screen/Wireless display**. Names may differ from different devices.

1. Turn on the projector, select **Screen Mirroring** as the **Input Source**, then press **OK** button on the projector/remote to switch to the interface of **Screen Mirroring for Android System**.

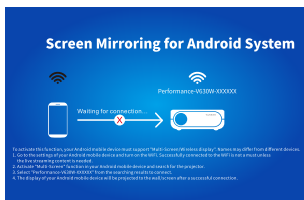

2. Activate **Multi-Screen** function on your Android device and search for the projector.
3. Select **Performance-V630W-XXXXXX** from the searching results to connect.
4. Your Android device display will be projected to the wall/screen after a successful connection.

Important Tips for Wireless Connection

- 1 The fluency of screen mirroring with wireless connection will be affected by the network environment. A bandwidth of 100Mbit or more is recommended when using screen mirroring.
- 2 Make sure your mobile device is close to the projector when using wireless connection. A distance within 3.3ft is recommended.
- 3 Some mobile devices may not support screen mirroring due to the compatibility.
- 4 If the projected image freezes when you switch the screen mirroring interfaces, please long press **OK** button for 5 seconds on the projector/remote to do a reset, and the reset process will complete in 2 minutes, please wait patiently.

* Upgrade the Firmware Version of Screen Mirroring

When there is a newer version, you will see **Discover new firmware...** on the projected screen, please press **OK** button on the projector/remote and follow the steps to upgrade the firmware version of screen mirroring as needed.



Notes:

- 1 Make sure the projector is connected to **WIFI** and **DO NOT** power off during updating.
- 2 It takes around 6-8 minutes for the update completes, please wait patiently.
- 3 The screen mirroring system will restart once the upgrade is completed.

Screen Mirroring with the Original USB Cable

For iOS System

1. Turn on the projector, select **Screen Mirroring** as the input source to enter the interface of **Screen Mirroring for iOS System**.
2. Connect your iOS mobile device to the **5V Out** port of the projector with the **ORIGINAL** lightning cable.
3. Select **Trust** in the pop-up window of **Trust This Computer**.

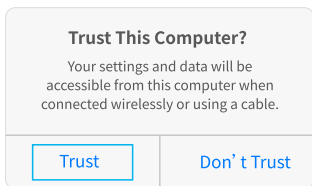

4. The display of your iOS mobile device will be projected to the wall/screen after a while.



Tip:

If the projection fails, please unplug the lightning cable from the projector and repeat the steps mentioned above.

For Android System

1. Turn on the projector, select **Screen Mirroring** as the input source, then press the **OK** button on the projector/remote to switch to the interface of **Screen Mirroring for Android System**.
2. Go to the settings of your mobile device, find **Developer options** and turn on **USB debugging**.



Tip:

The steps to turn on **Developer options** vary from different models of Android device. You may check it from Internet or contact us for the detailed steps. We take **Samsung Galaxy S8+** as an example.

- * Go to settings of your Android device, then tap **About phone** > **Software information** > **Build number**.
- * Continuously tap on **Build number** for several times until it shows **Developer mode had been turned on**.
- * Get back to the settings of your mobile device, it will show **Developer options**.

3. Connect your Android mobile device to the **5V Out** port of the projector with the **ORIGINAL** USB cable.
4. Tap **OK** when your Android mobile device pops out the window of **Allow USB debugging?**, then your Android device will be projected to the wall/screen.

Allow USB debugging?

USB debugging is intended for development purposes only. It can be used to copy data between your computer and your device, install applications, and read log data.

CANCEL

OK

Notes:

- 1 The USB cable **MUST** be the **ORIGINAL** cable or the cable which can transfer the data, otherwise screen mirroring may fail. You can plug the cable into your laptop to check the availability of transferring the data.
- 2 Some mobile devices may not support screen mirroring due to the compatibility.
- 3 Some Android mobile devices may only transfer the display without audio due to the protocol restrictions.

PROJECTION DISTANCE&SIZE

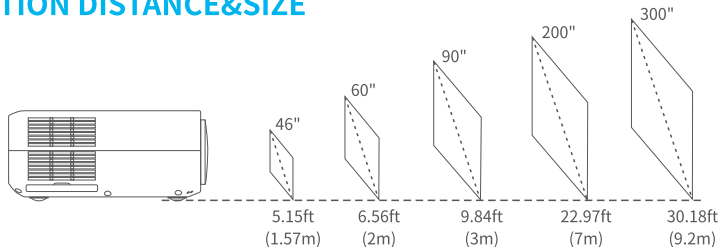

- * The recommended projection distance varies with different projection contents. Please adjust the distance between the wall/screen and the projector properly as needed.
- * Ambient darkness will improve the clarity of the projected images.

SPECIFICATION

Display Technology	LCD	Light Source	LED
Resolution	Native 1920 X 1080	Input Signal	576i, 720P, 1080i, 1080P
Installation Type	Front/Rear/Ceiling	Aspect Ratio	4:3/16:9/Auto
Focus	Manual	Manual/Digital Keystone	±15°/±50°
Speaker	5W/4ohm	Power Supply	AC 100-240V, 50/60Hz
Unit Dimension	315 x 235 x 109mm (12.4 x 9.3 x 4.3inches)	Unit Net Weight	2.7kg(5.95lb)
Photo FormatSupported	BMP/JPG/PNG/GIF	Audio Format Supported	AAC/MP2/MP3/PCM/FLAC/WMA
Video Format Supported	AVI/MP4/MKV/FLV/MOV/ RMVB/MPEG2/MPEG1/ 3GP/H.264/XVID/JPEG	Ports	HD In x 2/USB x 1/5V Out x 1/ Audio Out x 1/AV In x 1/VGA x 1/ Memory Card Slot x 1
Mounting Screws	M4 Metric	Number of Screw	4

TROUBLESHOOTING GUIDE

1. The content from Hulu, Netflix, and similar services can not be mirrored or cast.?

* Due to the copyright restriction from Hulu, Netflix, and similar services, the contents MAY NOT be mirrored or cast.

2. What should I do if I want to watch the content from Hulu, Netflix, and similar services via the projector?

* Please prepare a Fire TV stick , Roku stick or Chromecast™ (not included), then connect it to the projector to watch the content.

3. Blurry Image

* Adjust focus ring/keystone.

* Projector and screen/wall must be in effective distance.

4. Remote Unresponsive

* Make sure remote points at IR receiver directly.

* Do not cover IR receiver.

* Try a new pair of AAA batteries.

5. Upside Down Images

* Go to Menu > PICTURE > Projection Mode to flip the projection image.

6. Factory Reset

* Go to Menu > OPTION > Restore Factory Default to restore the projector to default settings.

VANKYO SUPPORT

North America support@ivankyo.com

United Kingdom support.uk@ivankyo.com



www.ivankyo.com



[@VankyoOfficial](https://www.facebook.com/VankyoOfficial)



VANKYO