

Leisure 495W

USER MANUAL

Please read this manual thoroughly before using and keep it for future reference.

CONTENT

WHAT'S INCLUDED	01
NOTICE.....	01
PRODUCT OVERVIEW	02
QUICK START	03
MULTIMEDIA CONNECTION	05
USB Disk Connection	05
HD Connection	07
AV Connection	07
SCREEN MIRRORING	08
For iOS System	08
For Android System	11
For Windows 10 System.....	12
SCREEN CASTING	14
BLUETOOTH CONNECTION	15
SETTINGS.....	16
Settings for Screen Mirroring Module	16
Settings for the Projector System	17
PROJECTION DISTANCE&SIZE.....	19
SPECIFICATION	20
TROUBLESHOOTING GUIDE	21

WHAT'S INCLUDED

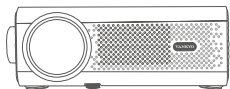

Projector



Remote (Batteries Not Included)



User Manual

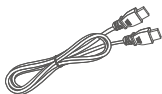

HD Cable

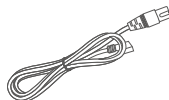

Power Cable

NOTICE

Recommended

Video, Movie

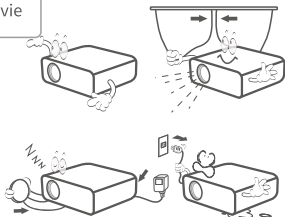

NOT Recommended

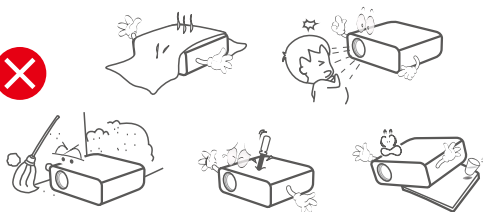

PRODUCT OVERVIEW

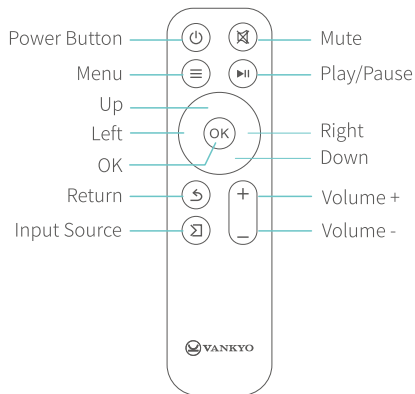
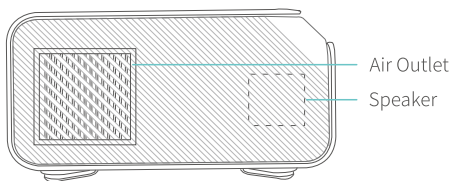
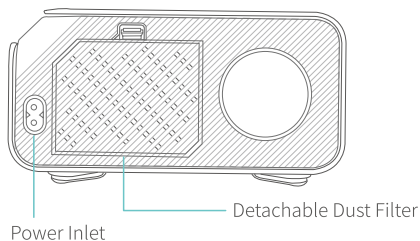
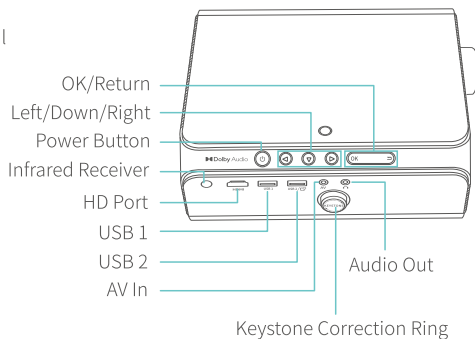
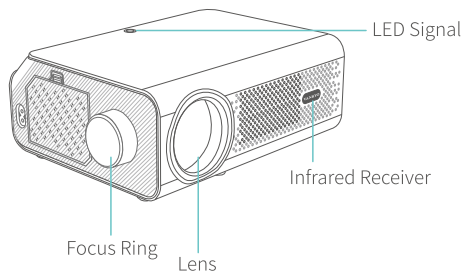

QUICK START

1. Projector Installation

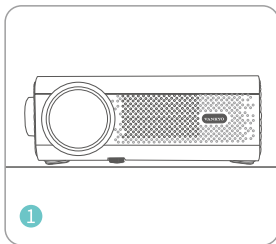

Horizontal Placement

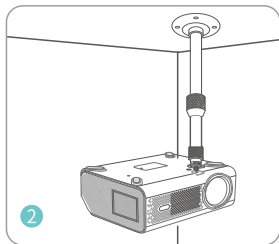

Ceiling Mounting

Note:

Whichever installation option you select, please make sure:

1. the projector is centered directly in front of the wall/screen, but not tilted or placed at an angle toward the wall/screen;
2. to select the corresponding projection mode so the images can be projected correctly.

2. Power On/Off

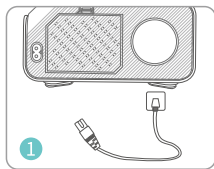

Plug the power cord into an outlet.

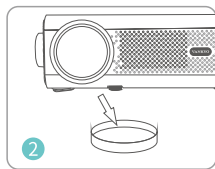

Take off the lens cover.

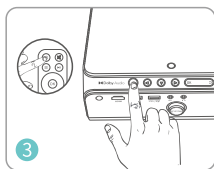

Press the **Power Button** to turn on the projector.

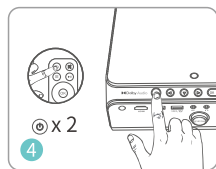

Press the **Power Button** twice to turn off the projector.

3. Images Adjustment

- 1 Rotate the Keystone Correction Ring to correct Vertical Keystone Distortion until the image is evenly rectangular.

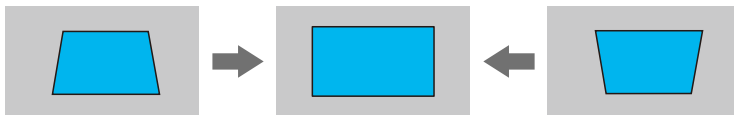

- 2 Rotate the Focus Ring to sharpen the Image Focus until the blurred image becomes clear.

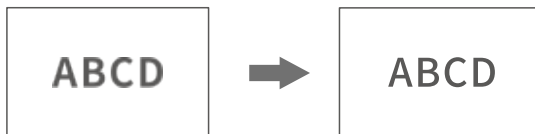

- 3 In Homepage interface, enter Setting > Image Scaling to enlarge or reduce the Image Size from 75% to 100% (optional).

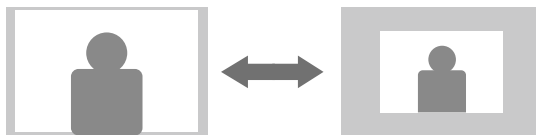



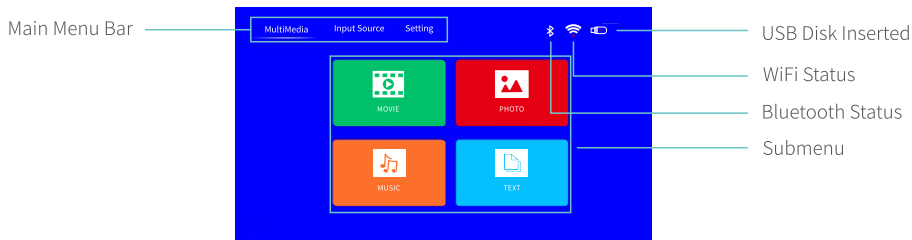

4. Homepage Overview

The default interface after booting is Homepage as shown.



In **Homepage** interface, when the underscore cursor locates at the **Main Menu Bar**, press \leftarrow / \rightarrow to toggle through menu items including **MultiMedia**, **Input Source** and **Setting**. Press \downarrow / **OK** to enter the corresponding **Submenu**, then press \leftarrow to return to **Main Menu Bar**.

- * **MultiMedia** page displays file categories of **MultiMedia Input**(typically for a USB Disk), including **MOVIE**, **PHOTO**, **MUSIC** and **TEXT**.
- * **Input Source** page displays three categories of input source, including **MULTISCREEN**, **HDMI** and **AV**.
- * **Setting** page will guide you through all settings for the projector.
- * The icon  will light up when the projector is successfully connected to a Bluetooth audio device.
- * The icon  will turn into  when the projector is successfully connected to a wireless network.
- * The icon  will turn into  when a USB disk is inserted.

MULTIMEDIA CONNECTION

USB Disk Connection

Step 1: Turn on the projector and insert your USB disk into the **USB 1/USB 2** port of the projector.

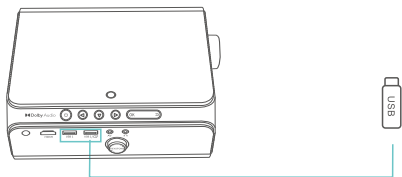

Step 2: Go to **Homepage > MultiMedia** and select the file category you would like to display among **MOVIE**, **PHOTO**, **MUSIC** and **TEXT**, then enter the inserted USB Disk to check all files stored.

Step 3: To play a video file, please follow the below steps:

- 1 Select **MOVIE** in the **MultiMedia** interface to correspondingly read video files stored.
- 2 Press **OK** / **▶** on the projector/remote for a certain video file to enter full-screen display.
- 3 Press **OK** on the projector or press **OK/Menu** on the remote when playing back a video to bring up the toolbar to control the video playing.

Note:

Operation for playing a photo file, a music file and a text file is the same with that for playing a video file, but please make sure to select the correct file category; that is, for playing a photo file, select **Photo** in **MultiMedia** interface; likewise, for music, select **MUSIC**, for text, select **TEXT**.

Step 4: Press **⏪** on the projector/remote to go back to **Homepage**.

File Category	Format Supported	File Category	Format Supported
Video	3GP/AVI/MKV/MOV/MP4/MPG/ VOB/MPG/RMVB/RM	Music	MP3/WMA/OGG/AAC/FLAC/WAV
Photo	JPEG/BMP/PNG	Text	TXT

HD Connection

Step 1: Turn on the projector and connect your device to the **HDMI port** of the projector with the provided HD cable.

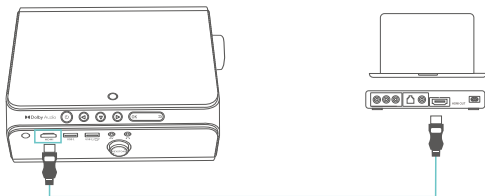

Step 2: Go to **Homepage > Input Source**, select **HDMI** as the input source, then the contents of your device will be mirrored to the screen/wall.

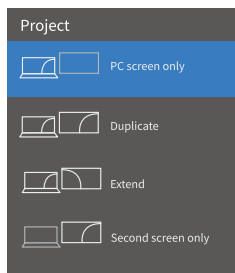

Tip:

For **Windows 7 or higher** system, press the "**Windows Logo + P**" key combination to access the below four display modes.

- ① **PC screen only** option displays contents on computer screen only.
- ② **Duplicate** option displays the same contents on both computer screen and projected screen.
- ③ **Extend** option splits the display between the computer screen and the projected screen.
- ④ **Second screen only** option displays contents only on the projected screen.

AV Connection

Step 1: Turn on the projector and connect your device to the **AV Port** of the projector with an AV cable(not included).

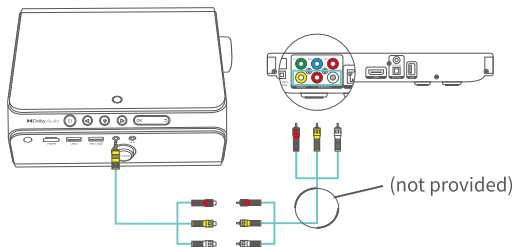

Step 2: Go to Homepage > Input Source, select AV as the input source, then the contents of your device will be mirrored to the screen/wall.

SCREEN MIRRORING

For iOS System

Screen Mirroring via Router's WiFi

- 1 Go to Homepage > Input Source, select MULTISCREEN as the input source to enter the CAST interface.

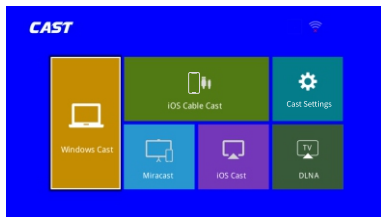

- 2 Select **Cast Settings > WiFi Setting** to search and connect the projector to your router's WiFi.

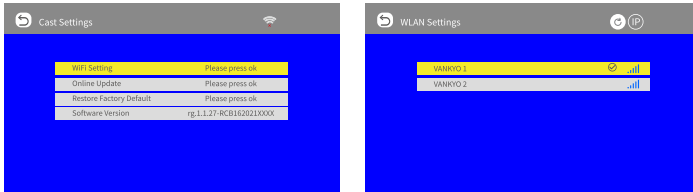

- 3 Enter WiFi settings of your iOS device and connect it to the same router's WiFi.
- 4 Return the screen back to **CAST** interface, then select **iOS Cast** to enter the following interface.



- 5 Activate **Screen Mirroring/AirPlay Mirroring** in the **Control Center** of your iOS device and search for the projector.
- 6 Select **LEISURE-495W-XXXX-(icast)** from the searching list to connect.

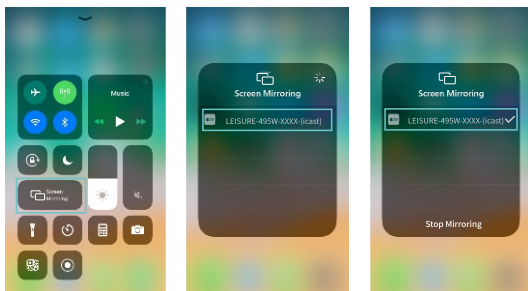

- 7 The contents on your iOS device will be mirrored to the wall/screen after a successful connection.

Tip:

To activate screen mirroring function of your MacBook, please follow the below steps:

- 1 Click **Control Center** icon in the menu bar at the top of the Mac screen.
- 2 Click **Screen Mirroring** to search for the projector.
- 3 Select **LEISURE-495W-XXXX-(icast)** to connect.

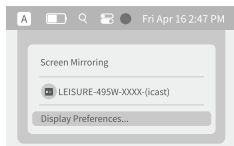
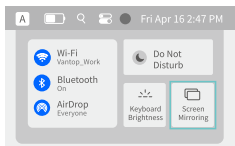

Screen Mirroring via a Lightning Cable

- 1 Go to Homepage > Input Source, select MULTISCREEN as the input source to enter the CAST interface.
- 2 Select iOS Cable Cast to enter the following interface.

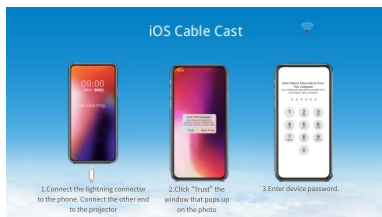

- 3 Connect your iOS mobile device to the USB 2 port of the projector using the ORIGINAL lightning cable.
- 4 Select **Trust** in the pop-up window of Trust This Computer?.

Trust This Computer?

Your settings and data will be accessible from this computer when connected wirelessly or using a cable.

- 5 The contents on your iOS device will be mirrored to the wall/screen after a successful connection.

For Android System

To activate this function, please make sure your Android device supports **Multi-screen/Wireless display**. Names may differ from one Android device to another.

- 1 Turn on the WiFi switch on your Android device.

Note:

Successful WiFi connection is not a must, but please make sure the WiFi switch on your Android device is ON.

- Go to **Homepage > Input Source**, select **MULTISCREEN** as the input source to enter the **CAST** interface.
- Select **Miracast** to enter the following interface.



- Activate **Multi-screen** function on your Android device and search for the projector.
- Select **LEISURE-495W-XXXX** from the searching list to connect.
- The contents on your Android device will be mirrored to the wall/screen after a successful connection.

For Windows 10 System

To activate this function, your Windows 10 device must support the **Miracast** feature.

- Turn on the WiFi switch on your Windows 10 device.

Note:

Successful WiFi connection is not a must, but please make sure the WiFi switch on your Windows 10 device is ON.

- Go to **Homepage > Input Source**, select **MULTISCREEN** as the input source to enter the **CAST** interface.
- Select **Windows Cast** to enter the following interface.

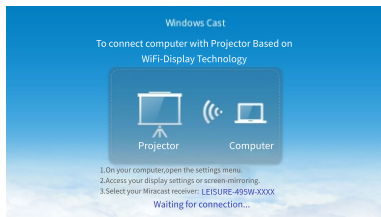

- 4 Press the "Windows Logo + P" key combination on your keyboard to enter PROJECT interface, then select "Connect to a wireless display" to search the projector.

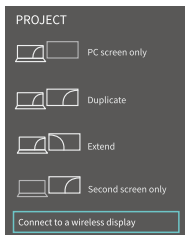

- 5 Select LEISURE-495W-XXXX from the searching list to connect.
- 6 The contents on your Windows 10 device will be mirrored to the wall/screen after a successful connection.

Notes:

- 1 The fluency of screen mirroring will be affected by the network environment. A bandwidth of 100Mbit or more is recommended when using screen mirroring.
- 2 Make sure your mobile device is close to the projector when using wireless connection. A distance within 3ft is recommended.
- 3 Some mobile devices may not support screen mirroring due to the compatibility.
- 4 Due to copyright restrictions of Hulu, Netflix, and similar services, the contents on these streaming services CAN NOT be mirrored or cast.
- 5 If the projected image freezes, please reboot the projector, then go to **Homepage > Input Source > MULTISCREEN > Cast Settings > Restore Factory Default** and select **Confirm** to do a reset on screen mirroring module.

SCREEN CASTING

- 1 Connect your mobile device and the projector to the same router's WiFi.
- 2 Go to **Homepage > Input Source**, select **MULTISCREEN** as the input source to enter the **CAST** interface.
- 3 Select **DLNA** to enter the following interface.

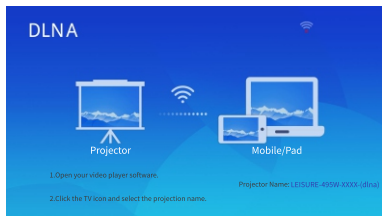

- Launch a video player APP on your mobile device and select a video to play.
- Tap  to search for the projector.
- Select LEISURE-495W-XXXX-(dlna) to connect.
- The contents on your device will be cast to the wall/screen.

Notes:

When you cast a video from your mobile device, the video will only be displayed on the projected screen and you can still use your mobile device without interrupting the video or showing any of your other content.

BLUETOOTH CONNECTION

The projector supports connection with Bluetooth audio devices (typically Bluetooth speakers/earphones/soundbars). It allows you to get good-quality audio output from a streaming device or other video source connected to your projector.

- Make sure the Bluetooth audio device is ready to pair.
- Go to **Homepage > Setting**, then enter **Connection Setting > Bluetooth** to access the following interface.

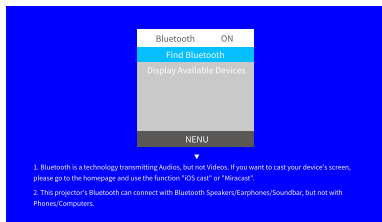

- Press  to turn on Bluetooth of the projector and search for the Bluetooth audio device to connect.
- After a successful connection, the Bluetooth icon on the Homepage will light up.

Notes:

- * When a Bluetooth audio device is paired with the projector, the built-in speaker system and **Audio Out** port of the projector are disabled.
- * To turn off **Bluetooth** of the projector, please go to **Homepage > Setting > Connection Setting > Bluetooth**, then press **<** ; or you can press **>** on the remote to quickly turn off **Bluetooth** in the course of screen mirroring.

SETTINGS

Settings for Screen Mirroring Module

Go to **Homepage > Input Source**, select **MULTISCREEN** as the input source to enter the **CAST** interface, then enter **Cast Settings** to access setting options exclusive for screen mirroring module.

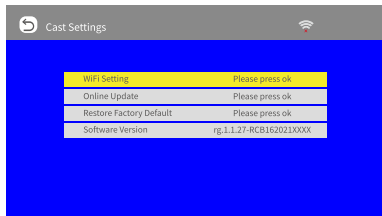

1 WiFi Setting

Connect the projector to your router's WiFi.

2 Online Update

Enter to update the firmware of screen mirroring module when a newer version is available.

3 Restore Factory Default

Restore the screen mirroring module to the factory settings.

4 Software Version

Check system version of the projector.

Settings for the Projector System

How to Enter

Option 1:

Go to Homepage > Setting to access Picture Setting, System Setting and Connection Setting. Be sure to press

⏵ to check the full list of setting options.

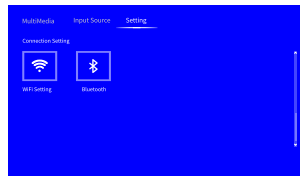
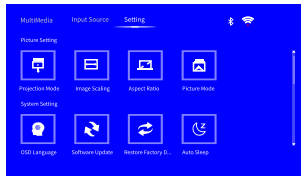

Option 2:

In any interface, press ⏸ on the remote to quickly access Picture Setting, System Setting and Connection Setting.

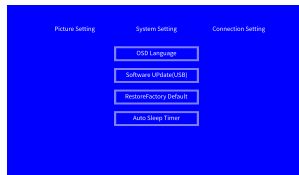

1. Picture Setting

1 Projection Mode

Depending on how you position the projector, you may need to change projection modes so that the images can be projected correctly. Available options include **Normal Front(default)**, **Normal Back**, **Invert Front** and **Invert Back**.

2 Image Scaling

Enter to enlarge or reduce image size from 75% to 100%.

3 Aspect Ratio

Enter to change **Aspect Ratio** among **AUTO(default)**, **4:3** and **16:9**.

Note:

Select **AUTO**, then the projector will set the aspect ratio automatically according to the input source.

4 Picture Mode

Options include **Standard**, **Soft**, **User** and **Dynamic**. You can use the **Left/Right** button to toggle through all the available options.

2. System Setting

1 OSD Language

Enter to select a language for the projector.

2 Software Update(USB)

Update the projector using a USB disk with upgrade file named as **YG460R3_ST58.bin**. (Contact our customer service to get the upgrade file.)

3 Restore Factory Default

Restore the projector to the factory settings.

4 Auto Sleep Timer

Set the time duration for the projector to turn off automatically. Options include **Never**, **4Hours**, **6Hours** and **8Hours**.

3. Connection Setting

1 WiFi Setting

Connect the projector to your router's WiFi.

2 Bluetooth

Turn on to search and connect the projector to any Bluetooth audio device (typically Bluetooth speakers/earphones/soundbars) and get good-quality audio output.

PROJECTION DISTANCE&SIZE

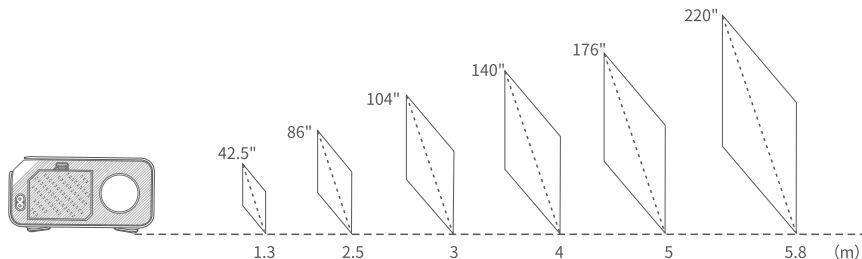

* The recommended projection distance varies with different projection contents. Please adjust the distance between the wall/screen and the projector properly as needed.

* Ambient darkness will improve the clarity of the projected images.

SPECIFICATION

Display Technology	LCD	Light Source	LED
Resolution	Native 1920 x 1080	Input Signal	576i, 720P, 1080i, 1080P
Installation Type	Front/Rear/Ceiling	Aspect Ratio	4:3/16:9/Auto
Focus	Manual	Electronic Keystone	±15°
Speaker	3W/4ohm	Power Supply	AC 100-240V, 50/60Hz
Unit Dimension	4.84 x 7.01 x 3.35 inches (123 x 178 x 85mm)	Unit Net Weight	3.086 lbs(1.4kg)
Photo Format Supported	JPG/E/BMP/PNG	Audio Format Supported	MP3/WMA/OGG/AAC/FLAC/WAV
Mounting Screws	1/4"	Screw Number	Not included
Video Format Supported	3GP(H.263,MPEG4)/AVI(XVID,DIVX,H.264)/MKV(XVID,H.264,DIVX)/FLV(FLV)/MOV(H.234)/MP4(PEG4,AVC)/MPG(MPEG1)/VOB(MPEG2)/MPG(MPG-PS)/RMVB(RV40)/RM		
Ports	USB Port x 2 / HD In x 1 / AV In x 1 / Audio Out x 1		

TROUBLESHOOTING GUIDE

- 1 The contents from Hulu, Netflix, and similar services can not be mirrored or cast.**
 - * Due to the copyright restriction from Hulu, Netflix, and similar services, the contents CAN NOT be mirrored or cast.
- 2 What should I do if I want to watch the content from Hulu, Netflix, and similar services via the projector?**
 - * Please prepare a Fire TV stick , Roku stick or Chromecast™ (not included), then connect it to the projector.
- 3 Blurry Image**
 - * Adjust focus ring/keystone.
 - * Projector and screen/wall must be in effective distance.
- 4 Remote Unresponsive**
 - * Make sure remote points at IR receiver directly.
 - * Do not cover IR receiver.
 - * Try a new pair of AAA batteries.
- 5 Upside Down Images**
 - * Go to **Homepage > Setting > Picture Setting > Projection Mode** to flip the projection image.
- 6 Factory Reset**
 - * Reset the screen mirroring module to the factory settings
Go to **Homepage > Input Source > MULTISCREEN > Cast Settings > Restore Factory Default**, then select **Confirm** to do a reset.
 - * Reset the projector to the factory settings
Go to **Homepage > Setting > System Setting > Restore Factory Default** or press  on the remote in any interface to access **System Setting** and enter **Restore Factory Default**, then select **Confirm** to reset the projector to default settings.

FCC Statement

Any Changes or modifications not expressly approved by the party responsible for compliance could void the user's authority to operate the equipment. This device complies with part 15 of the FCC Rules. Operation is subject to the following two conditions:

- (1) This device may not cause harmful interference, and
- (2) this device must accept any interference received, including interference that may cause undesired operation.

NOTE: This equipment has been tested and found to comply with the limits for a Class B digital device, pursuant to part 15 of the FCC

Rules. These limits are designed to provide reasonable protection against harmful interference in a residential installation. This equipment generates, uses and can radiate radio frequency energy and, if not installed and used in accordance with the instructions, may cause harmful interference to radio communications. However, there is no guarantee that interference will not occur in a particular installation. If this equipment does cause harmful interference to radio or television reception, which can be determined by turning the equipment off and on, the user is encouraged to try to correct the interference by one or more of the following measures:

- Reorient or relocate the receiving antenna.
- Increase the separation between the equipment and receiver.
- Connect the equipment into an outlet on a circuit different from that to which the receiver is connected.
- Consult the dealer or an experienced radio/TV technician for help.

This equipment complies with FCC radiation exposure limits set forth for an uncontrolled environment. This equipment should be installed and operated with minimum distance 20cm between the radiator& your body.

This transmitter must not be co-located or operating in conjunction with any other antenna or transmitter.

ISED Warning

This device complies with Industry Canada licence-exempt RSS standard(s). Operation is subject to the following two conditions:

- (1) this device may not cause interference, and
- (2) this device must accept any interference, including interference that may cause undesired operation of the device.

Le présent appareil est conforme aux CNR d'Industrie Canada applicables aux appareils radio exempts de licence.

L'exploitation est autorisée aux deux conditions suivantes:

- (1) l'appareil ne doit pas produire de brouillage, et
- (2) l'utilisateur de l'appareil doit accepter tout brouillage radioélectrique subi, même si le brouillage est susceptible d'en compromettre le fonctionnement.

Le présent appareil est conforme

Après examen de ce matériel aux limites d'intensité de champ RF, les utilisateurs peuvent sur l'exposition aux radiofréquences et la conformité and compliance d'acquérir les informations correspondantes. La distance minimale du corps à utiliser le dispositif est de 20cm.

Operation of this device in the band 5150-5250 MHz is restricted to indoor use only.

Le fonctionnement de cet appareil dans la bande 5150-5250 MHz est limité à une utilisation?den intérieur uniquement.

VANKYO SUPPORT

North America support@ivankyo.com

United Kingdom support.uk@ivankyo.com