

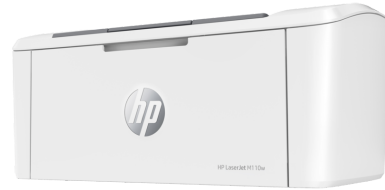

# HP LaserJet M110w Printer

An efficient, high-quality laser printer that fits your space and budget. Get fast printing from HP's smallest laser in its class,<sup>1</sup> plus the time-saving HP Smart app.<sup>2,3</sup> Count on professional-quality laser printing and seamless setup.



This printer is intended to work only with cartridges that have a new or reused HP chip, and it uses dynamic security measures to block cartridges using a non-HP chip. Periodic firmware updates will maintain the effectiveness of these measures and block cartridges that previously worked. A reused HP chip enables the use of reused, remanufactured, and refilled cartridges. More at: <http://www.hp.com/learn/ds>

## Highlights

- The world's smallest laser printer in its class
- Instant Ink for toner service available
- Quality and reliability you expect from industry leader
- Print speed up to 20 ppm
- Intuitive, easy to use
- Easy mobile printing and scanning with the HP Smart App
- HP Smart App; Apple AirPrint™; Mopria™ Certified; Wi-Fi® Direct Printing
- HP Auto-On/Auto-Off technology

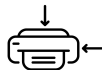

## HP's smallest laser in its class

- HP's smallest laser in its class<sup>1</sup> designed for efficient performance.
- Maximise your uptime with print speeds up to 20 ppm in A4.<sup>4</sup>
- Get wireless with self-reset to help you stay connected.<sup>5</sup>
- Smartly and elegantly designed, so it's simple and intuitive to use.

## Productivity from your phone

- Get high-quality scanning, and share to Dropbox, Google Drive or cloud – from your phone with HP Smart app.<sup>2</sup>
- Quickly access and print documents on your smartphone, from Dropbox and Google Drive, using HP Smart app.<sup>2</sup>
- With HP Smart app, take a photo as a copy, and send it to your printer from your smartphone.<sup>2</sup>
- Eliminate steps in repetitive tasks with Shortcuts.<sup>2</sup> Scan to the cloud, email, and more in just a tap.<sup>2</sup>

## Never run out<sup>6</sup> and save up to 50%<sup>7</sup> with Instant Ink for laser printing

- Never run out of toner for your laser printer.<sup>6</sup> Convenient toner replacements and smart delivery included.
- Save up to 50% with Instant Ink.<sup>7</sup> Enroll to get toner, delivery and recycling.
- Peace of mind with plan flexibility to change or cancel anytime at no cost.<sup>8</sup>
- Help us put plastic back into printers with prepaid recycling service included.<sup>9</sup>

## Help save resources without sacrificing performance

- HP Auto-On/Off Technology – intelligence can turn your printer on when you need it and off when you don't.<sup>10</sup>
- This HP LaserJet meets ecolabel requirements, including ENERGY STAR® and BLUE ANGEL.

## Product walkaround

HP LaserJet M110w Printer shown

1. Intuitive Control Panel
2. 150 sheet Input Tray
3. 100 sheet Output Bin
4. World's Smallest Laser in its Class

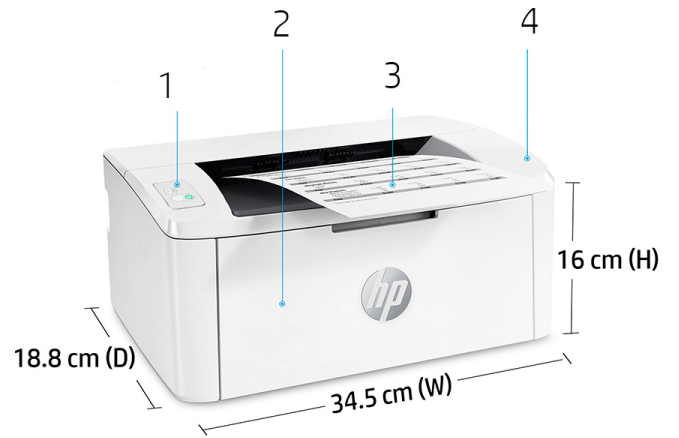

## Accessories, Supplies and Support

Supplies	W1420A HP 142A Black Original LaserJet Toner Cartridge (950 pages)
Accessories	
Service and Support	U35PQE HP 3 year Care Pack with Standard Exchange for LaserJet Printers U35PLE HP 3 year Care Pack with Next Day Exchange for LaserJet Printers U35PTE HP 3 year Care Pack with Return to Depot Support for LaserJet Printers(U35PQE: all EMEA countries, except ME, Africa, South Africa, Israel, Turkey, U35PLE: Austria, Belgium, Denmark, Finland, France, Germany, Ireland, Italy, Netherlands, Norway, Portugal, Spain, Sweden, Switzerland, UK, Czech, Greece, Hungary, Poland, Slovakia, U35PTE: ME, Africa, South Africa, Israel, Turkey)

## Technical specifications

Model	HP LaserJet M110w Printer
Product number	7MD66F
Functions	Print
Control panel	3 LEDs (Attention, Ready, Wireless); 3 buttons (Power, Cancel, Wireless)
<b>Print</b>	
Print technology	Laser
Print speed <sup>1</sup>	<b>Black (A4, normal):</b> Up to 20 ppm
First page out <sup>2</sup>	<b>Black (A4, ready):</b> As fast as 8.5 sec ; <b>Black (A4, sleep):</b> As fast as 9.1 sec
Print resolution	<b>Black (best):</b> Up to 600 x 600 dpi; <b>Technology:</b> HP FastRes 600
Monthly duty cycle	Up to 8000 pages A4; <b>Recommended monthly page volume:</b> 100 to 1000
Printer smart software features <sup>3,4</sup>	HP Auto-On/Auto-Off <sup>1</sup> , HP Smart App <sup>2</sup>
Standard print languages	PCLm/PCLm5; URF; PWG
Print area	<b>Print margins</b> Top: 2 mm, Bottom: 2 mm, Left: 2 mm, Right: 2 mm; Maximum print area : 216 x 355.6mm
Duplex printing	None
Processor speed	500 MHz
<b>Connectivity</b>	
Standard	1 Hi-Speed USB 2.0 (device); Wireless 802.11b/g/n 2.4GHz
Mobile printing capability <sup>5</sup>	HP Smart App; Apple AirPrint™; Wi-Fi® Direct printing; Mopria™ Certified
Supported network protocols	TCP/IP: IPv4; IPv6; IP Direct Mode; LPD; SLP; Bonjour; WS-Discovery; BOOTP/DHCP/AutoIP; SNMP v 1/2/3; HTTP/HTTPS; WS Transfer; FQDN; DNS
Memory	<b>Standard:</b> 32 MB ; <b>Maximum:</b> 16 MB Flash ROM; 32 MB SDRAM; 32 KB NVRAM
<b>Media handling</b>	
Number of paper trays	<b>Standard:</b> 1 input tray ; <b>Maximum:</b> 1 input tray
Media types	Plain paper, envelope, postcard, label
Media size	<b>Custom (metric):</b> 105 x 148 to 216 to 355.6mm <b>Supported (metric):</b> A4; A5; A6; envelopes (C5, DL); custom

<b>Model</b>	HP LaserJet M110w Printer
<b>Product number</b>	7MD66F
<b>Media handling</b>	<b>Standard input:</b> 150-sheet input tray <b>Standard output:</b> 100-sheet output bin
<b>Media weight</b>	65 to 120 g/m <sup>2</sup>
<b>Input capacity</b>	<b>Tray 1:</b> Sheets: 150; Envelopes: 10 <b>Maximum:</b> Up to 150 sheets
<b>Output capacity</b>	<b>Standard:</b> Up to 100 sheets Envelopes: Up to 10 envelopes <b>Maximum:</b> Up to 100 sheets
<b>Compatible operating systems</b>	Windows 11; Windows 10; macOS 10.15 Catalina; macOS 11 Big Sur; Linux
<b>Compatible network operating systems</b>	Windows 11; Windows 8; Windows Server; Linux
<b>Minimum system requirements</b>	<b>Windows:</b> Microsoft® Windows® 11, 10, 7 SP1: 32-bit or 64-bit, 2 GB available hard disk space, Internet connection, Microsoft® Internet Explorer or Edge. <b>Mac:</b> Apple® macOS Catalina (v10.15) macOS Big Sur (v11.0) macOS Monterey (v12.0); 2 GB HD; Internet required
<b>Software included</b>	No CD in box. Download software from hp.com or 123.hp.com
<b>Security management</b>	Password-protected network embedded Web server; enable/disable Network ports; SNMPv1/2/3 community password change
<b>Printer management</b>	HP Printer Assistant (UDC); HP Device Toolbox
<b>Dimensions and weight</b>	
<b>Printer dimensions (W x D x H)</b>	<b>Minimum</b> 346 x 189 x 159 mm; <b>Maximum:</b> 346 x 360 x 280 mm
<b>Printer weight</b>	3.8 kg
<b>Operating environment</b>	<b>Temperature:</b> 15 to 32.5°C <b>Humidity:</b> 30 to 70% RH
<b>Storage conditions</b>	<b>Temperature:</b> -20 to 60°C
<b>Acoustics</b>	<b>Acoustic power emissions:</b> 6.0 B(A) <b>Acoustic pressure emissions:</b> 48 dB(A)
<b>Power</b>	<b>Requirements:</b> 220V - 240V nominal @ +/-10% (min 198V, Max 264V), 50 - 60Hz nominal +/- 3Hz (min 47Hz, max 63Hz); <b>Consumption:</b> 361 watts (active printing), 2.3 watts (ready), 1.0 watts (sleep), 0.05 watts (Manual-off), 0.05 watts (Auto-off/Manual-on), 1.0 watts (Auto-off/Wake on USB); <b>Typical Electricity Consumption (TEC)<sup>5</sup>:</b> 0.239 kWh/Week (Blue Angel); 0.256 kWh/Week (Energy Star 3.0); <b>Power supply type:</b> Power requirements are based on the country/region where the printer is sold. Do not convert operating voltages. This will damage the printer and void the product warranty.
<b>Energy savings feature technology</b>	HP Auto-On/Auto-Off Technology
<b>Certifications</b>	RCM (Australia), TUV and GS Mark (Germany), BSMI (Taiwan), KC (South Korea), Ukraine, EAC, Eastern European approvals, CE Marking, FCC, UL, Singapore, etc. <b>Electromagnetic emission standard:</b> CISPR32:2012 & CISPR32:2015 /EN55032:2012 & EN55032:2015+AC:2016 - Class B; EN 61000-3-2:2014; EN 61000-3-3:2013; EN 55035:2017; FCC Title 47 CFR, Part 15 Class B/ICES-003, Issue 6 ENERGY STAR® certified <b>Telecom compliance:</b> Wireless: EU RED 2014/53/EU; EN 301 489-1 V2.2.3 / EN 301 489-17: V3.1.1; EN 300 328: V2.1.1 / EN301 893 V2.1.1; FCC Title 47 CFR, Part 15 Subpart C & E / RSS 247 Issue 1, 2015 & RSS 102 Issue 5, 2015; IEC 62311:2007 / EN62311:2008
<b>Sustainable impact specifications</b>	Recyclable through HP Planet Partners; Contains post-consumer recycled plastic
<b>Country of origin</b>	Made in Vietnam
<b>What's in the box<sup>7</sup></b>	7MD66F HP LaserJet M110w Printer; Power cord; HP Black LaserJet Toner Cartridge (yield: 300 pages); Setup Poster; Reference Guide; Warranty Guide; Flyer
<b>Warranty</b>	One-year limited warranty. Warranty and support options vary by product, country, and local legal requirements

Footnotes

- <sup>1</sup> Smallest in-class footprint compared only to dimensions of majority of personal monochrome laser printers and MFPs. Minimum dimensions used in this analysis. Buyers Lab August 2020 study commissioned by HP, based on a research survey OEM published specifications publicly available information as of 7/31/2020. Per HP, measured footprint for the HP LaserJet Pro M109–112 series is 658.06 square cm (102.0 square inches), and for the HP LaserJet Pro MFP M139–142 series is 949.84 square cm (147.226 square inches). Market share as reported by IDC Quarterly Hardcopy Peripherals Tracker - Final Historical 2020Q1 Worldwide. For details, please see: <http://www.keypointintelligence.com/HPsSmallestLaser>.
- <sup>2</sup> Requires the HP Smart app download. For details on local printing requirements see <http://www.hp.com/go/mobileprinting>. Certain features/software are available in English language only, and differ between desktop and mobile applications. Subscription may be required; subscription may not be available in all countries. See details at <http://www.hpsmart.com>. Internet access required and must be purchased separately. HP account required for full functionality. List of supported operating systems available in app stores.
- <sup>3</sup> Based on internal HP testing. Average timing estimate based on: 1) downloaded HP Smart app on mobile or desktop device, 2) setting up Shortcut, 3) scanning jobs which have more than 2-3 tasks associated with them (scan to email, save and rename, store to cloud, etc.). Average timing savings comparison based on using printer and desktop scan software to complete similar scanning tasks. Requires the HP Smart app download and supported HP printer. For details on local printing requirements see [www.hp.com/go/mobileprinting](http://www.hp.com/go/mobileprinting).
- <sup>4</sup> Measured using ISO/IEC 24734, excludes first set of test documents. For more information see <http://www.hp.com/go/printerclaims>. Exact speed varies depending on the system configuration, host OS, port-monitor, software application, driver, and document complexity.
- <sup>5</sup> Wireless operations are compatible with 2.4 GHz operations only. Learn more at <http://www.hp.com/go/mobileprinting>. Internet access required and must be purchased separately.
- <sup>6</sup> Based on plan usage, Internet connection to eligible HP printer, valid credit/debit card, email address, and delivery service in your geographic area.
- <sup>7</sup> Based on monthly subscription cost for HP Instant Ink 1,500 page plan vs. transactional cost per page of in-class monochrome A4 laser printers and MFPs that use original, standard-capacity integrated cartridges (toner and drum in one cartridge). Buyers Lab April 2020 study commissioned by HP, based on research of publicly available information as of 04/24/2020. Printers selected by market share as reported by IDC Quarterly Hardcopy Peripherals Tracker - Final Historical 2019Q4 for U.S. and Canada. For details and latest report, see: [http://www.keypointintelligence.com/HP\\_TonerService](http://www.keypointintelligence.com/HP_TonerService).
- <sup>8</sup> Change or cancel your plan at any time online. If you decide to cancel your HP Instant Ink plan you can go back to using HP original Standard or XL cartridges. Plan upgrades are effective immediately and the charges will be applied retrospectively or in the next billing cycle, depending on user choice. Plan downgrades and cancellations are effective after the last day of the current billing period. For full details go to <http://www.instantink.hpconnected.com/terms>.
- <sup>9</sup> Through the HP Planet Partners program (where available), recycled plastics are used as raw material and combined with other materials to help make new Original HP cartridges and other everyday products. For details: <http://www.hp.com/hprecycle>.
- <sup>10</sup> HP Auto-On/Auto-Off Technology capabilities subject to printer and settings; may require a firmware upgrade.

Technical specifications disclaimers

- <sup>1</sup> Measured using ISO/IEC 24734, excludes first set of test documents. For more information see <http://www.hp.com/go/printerclaims>. Exact speed varies depending on the system configuration, software application, driver, and document complexity.
- <sup>2</sup> Measured using ISO/IEC 17629. For more information see <http://www.hp.com/go/printerclaims>. Exact speed varies depending on the system configuration, software application, driver, and document complexity.
- <sup>3</sup> HP Auto-On/Auto-Off Technology capabilities subject to printer and settings; may require a firmware upgrade.
- <sup>4</sup> Requires the HP Smart app download. For details on local printing requirements see <http://www.hp.com/go/mobileprinting>. Certain features/software are available in English language only, and differ between desktop and mobile applications. Instant Ink subscription may be required. Instant Ink not available in all countries. See details at [www.hptonerservice.com](http://www.hptonerservice.com). Internet access required and must be purchased separately. HP account required for full functionality. List of supported operating systems available in app stores. Fax capabilities are for sending a fax only, and may require additional purchase. For more information, see: <http://www.hpsmart.com/mobile-fax>
- <sup>5</sup> Wi-Fi® is a registered trademark of Wi-Fi Alliance®. Wireless operations are compatible with 2.4 GHz operations only. Learn more at <http://www.hp.com/go/mobileprinting>. Wireless performance is dependent upon physical environment and distance from the access point. AirPrint and the AirPrint Logo are trademarks of Apple® Inc. The Mopria® Logo is a registered and/or unregistered trademark of Mopria Alliance, Inc. in the United States and other countries. Unauthorized use is strictly prohibited. Requires the HP Smart app download. For details on local printing requirements see <http://www.hp.com/go/mobileprinting>. Certain features/software are available in English language only, and differ between desktop and mobile applications. Instant Ink subscription may be required. Instant Ink not available in all countries. See details at <http://www.hptonerservice.com>. Internet access required and must be purchased separately. HP account required for full functionality. List of supported operating systems available in app stores. Fax capabilities are for sending a fax only, and may require additional purchase. For more information, see: <http://www.hpsmart.com/mobile-fax>
- <sup>6</sup> Power requirements are based on the country/region where the printer is sold. Do not convert operating voltages. This will damage the printer and void the product warranty. Energy Star value typically based on measurement of 115V device.
- <sup>7</sup> For yield information on the cartridge included with your printer, see <http://www.hp.com/go/toneryield>. Yield values measured in accordance with ISO/IEC 19752 and continuous printing. Actual yields vary considerably based on images printed and other factors.

